

**REDIEN**<sup>TM</sup>  
Japan

# PROFESSIONAL TRIMMER

MODEL Rn-1702

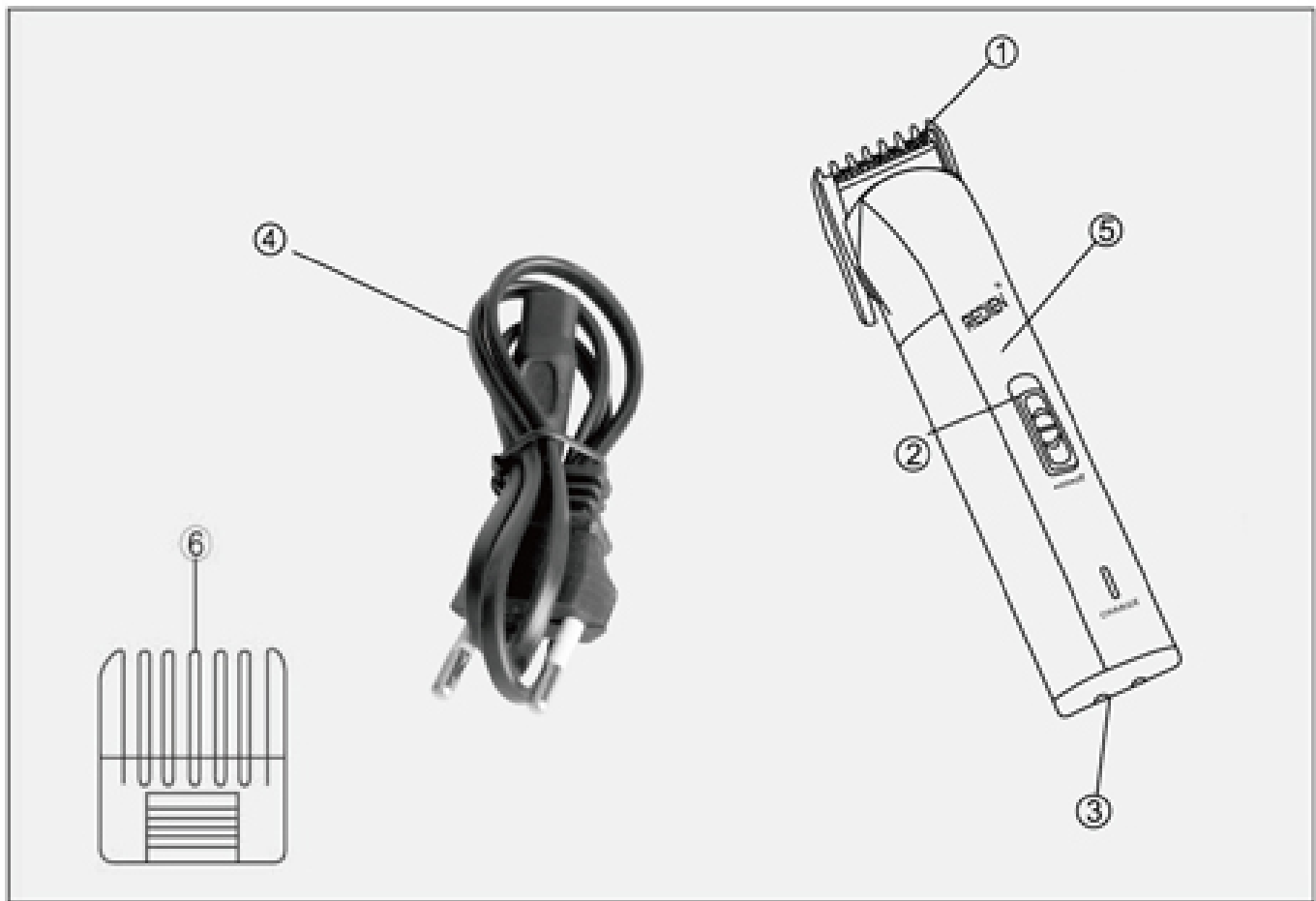



## DESCRIPTION OF PARTS

- Cutting head
- On/off switch
- Charging contacts
- Control lamp
- Clip-on comb attachment

## PREPARING FOR USE

- 1 The appliance as supplied by the manufacturer is not yet ready for use. **It must be electrically charged prior to use.**
- 2 Insert the plug of the battery charging stand 4 into a socket. Warning! This appliance must be charged at the specified voltage! You can store the remainder the charging stand 4 ( 230V 50Hz/60Hz ). In order to charge the appliance it should be placed in the battery charging stand 4 so that the control lamp 5 lights up. While the appliance is being charged, the switch must be set at "0" (the "0" must be visible). A charging period of 16 hours is required before initial use. Take care to keep the charging contacts 3 clean, as soiled charging contacts can interfere with the charging process. Overcharging of the appliance is not possible.
- 3 After charging the appliance is ready for use. It can be used with or without the clip-on comb attachment. To attach the clip-on comb attachment, slide it onto the cutting head 1 until it clicks into position. The appliance must be switched off while the clip-on comb attachment is being attached or removed.
- 4 The clip-on comb attachment is easily adjustable. Simply slide it up or down the cutting head 1. The hair can be cut to 4 different lengths ranging from approximately 3 mm to 6 mm. The position of the clip-on comb attachment on the cutting head determines the length of the haircut.
- 5 After using the appliance, switch it off and replace it in the battery charging stand 4 to be recharged - the control lamp 5 must light up. In order to retain the load capacity of the storage battery we recommend to use the storage battery until it is empty before reloading.



## REPLACING THE CUTTING HEAD

**Switch the appliance off before replacing the cutting head!**

If the performance of the appliance deteriorates after extended use, despite regular cleaning and maintenance, the cutting head 1 should be replaced (the cutting head can be ordered as a spare part from the Service Department). First remove the hexagonal screw on the cutting head 1 by means of the hexagonal spanner attached to the underside of the charging stand 4 in the direction "–" and remove the old cutting head (Fig.2). **Important: First remove the screw, then remove the cutting head!** Place the new cutting head on the main body of the appliance and screw on place with the spanner (direction "+").

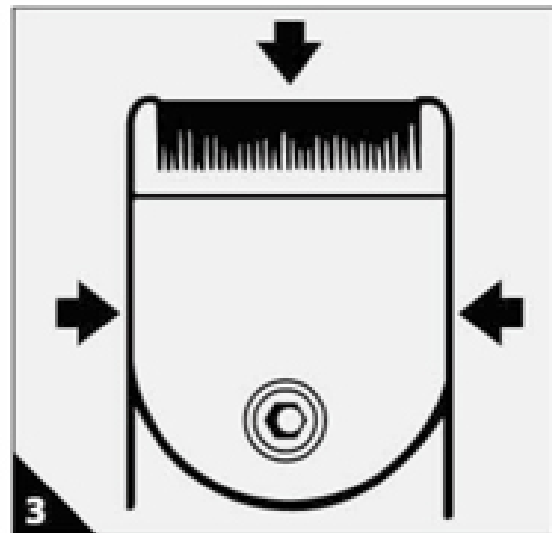
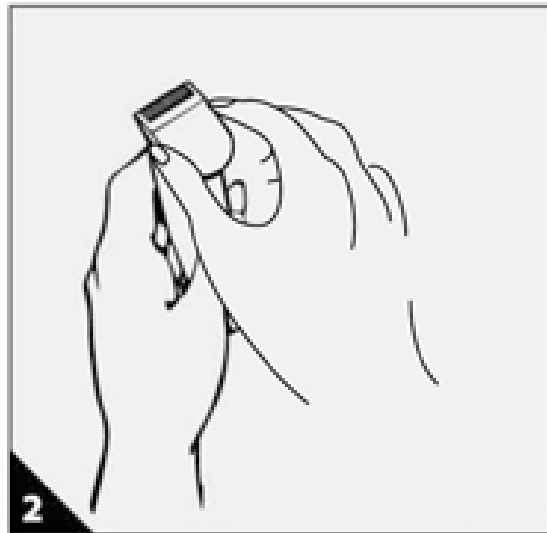

## CLEANING AND MAINTEN-ANCE OF THE APPLIANCE

**Switch the appliance off before cleaning or carrying out maintenance!**

In order to ensure that the appliance remains in perfect working order, it is important to note the following instructions:

In order to retain the load capacity of the storage battery we recommend to use the storage battery until it is empty before reloading.

Wipe the appliance with a cloth only (which may be slightly damp, if necessary). No solvents or lubricants may be used.

After use, take off the clip-on comb-attachment and remove any residual hair from the cutting head with a cleaning brush.

In order to ensure good cutting results and a long life, it is important to oil the cutting head frequently (Fig.3).

## PLEASE ALSO NOTE THE FOLLOWING

- During charging, the clipper should be placed in a position where there is no contact with moisture, water or other liquids possible.
- Never try to remove foreign bodies from the inside of the clipper with a pointed tool (e.g. tail comb).
- Always switch off the clipper before putting it down and between cutting operations.
- Protect the cable from damage. Do not pull the cable. If the cable should become damaged, contact the Service Department. The battery charging stand can be ordered as a spare part from the Service Department.
- Do not allow the cable to come into contact with hot surfaces.
- Do not touch the moving blades whilst the clipper is switched on.
- Do not use the clipper if the cutter set is damaged or broken, otherwise injuries could occur.
- The appliance should not be exposed to temperatures below 0°C or above +40°C for any great length of time. Avoid exposure to direct sunlight.
- Always turn the appliance off while it is being recharged (the "0" must be visible).
- Electrical appliances are not children's toys. Never allow a child to touch electrical equipment.
- If any problems or irregularities arise while the appliance is being used it must be switched off and the plug should be pulled out of the socket. Send the complete clipper with the adapter to the Service Department to be checked.
- No accessories or battery charging stands other than those supplied by may be used.
- Stubborn marks on the casing can be removed with a cloth moistened with normal household cleaning spirit. Beware inflammable! Never use petrol, paint thinners or abrasive cleaning agents.

**The clipper is fitted with nickel-cadmium batteries, which have to be disposed of specially. If your clipper is defective, return it to the Service Department for testing and we will, if necessary, dispose of the batteries properly.**

## DISPOSING OF THE BATTERY

**When you discard your shaver in due course, please remove the battery. Do not throw the battery away with the normal household waste. But hand it in separately at an officially assigned collection point.**